

Item	Qty.	Description
1	1	28.5"w x 95"h Gravitee Panel
2	1	95"h Gravitee Hinge - 70°
3	1	46"w x 95"h Gravitee Panel
4	1	38"w x 95"h Gravitee Panel
5	1	95"h Gravitee Hinge - 160°
6	1	28.5"w x 95"h Gravitee Panel
A	1	42.9"w S44 Horizontal Extrusion
B	1	42.9"w S44 Horizontal Extrusion
--	1	1/4" spacer for Monitor Mount

Steps:

- 1) Attach horizontals [A,B] between verticals of Panel [3].
- 2) Connect Gravitee Panels & Hinges together in numerical order, as shown.
- 3) Apply front SEG graphic to assembled frame.
- 4) Install Monitor Mount to horizontals [A,B] using supplied bolts & spacer.
See **Monitor Mount Attachment** detail.
- 5) Connect light to top of panel [6].
See **Light Attachment** detail.

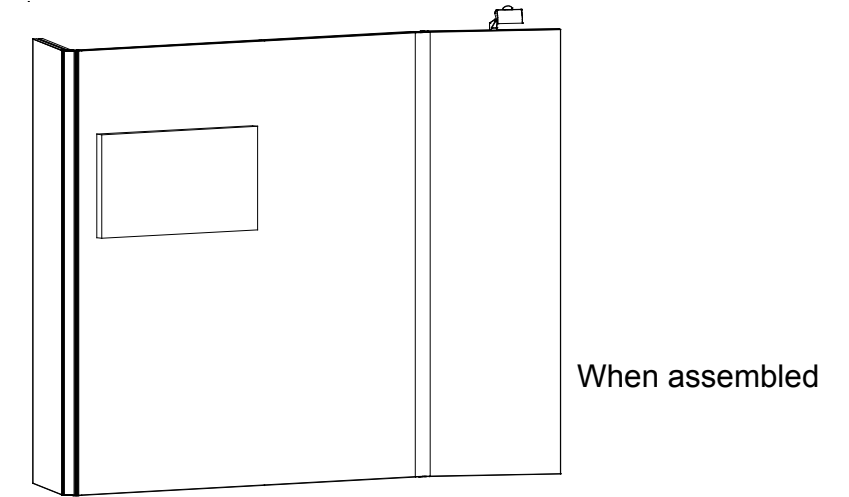
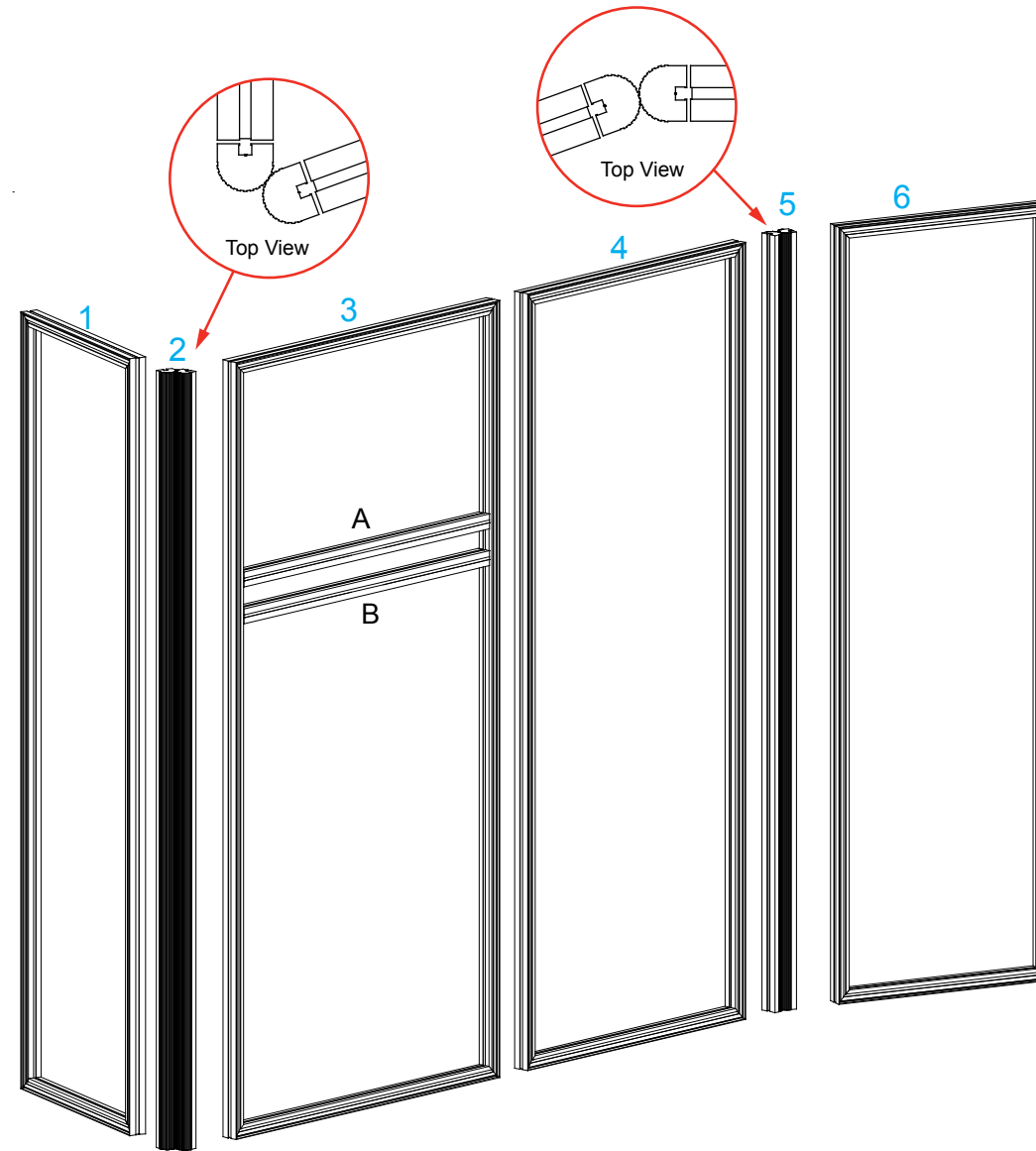

*** Light Attachment**

Lock Clip into Groove of Horizontal Extrusion, then slide Light onto Clip.

Lock into groove of horizontal

Slide light into light receiving hardware

SEG Graphic Installation

It is important to first insert graphic into each alternate corner then to the sides of the frame. If this is not done, graphic will not fit into the frame correctly.

Step 1
Insert corner A. Turn edge of graphic so silicon welt is perpendicular to face of graphic. Insert narrow side of welt with fabric to outside into the channel. Repeat for other side of this corner.

Step 2
Repeat Step 1 for opposite corner C, then insert corner B, followed by corner D, to complete the installation of the corners.

Step 3
Once all corners are inserted, press one silicon edge into channel from corners and work toward the center. Make sure welt is fully inserted into channel. Continue until all sides are done. Smooth out edges of graphic.

Graphic Removal

To remove the graphic from the frame, locate the fabric pull tab. Gently pull up on the tab to remove the fabric.

*** Monitor Mount Attachment**

Slide V4 connectors into groove of horizontal extrusions; tighten set screws to secure.

Use bolts to connect Monitor Mount to V4 connectors.

Monitor Mount installs over SEG graphic.

Note: Use supplied 1/4" spacer between SEG graphic & V4, as shown.

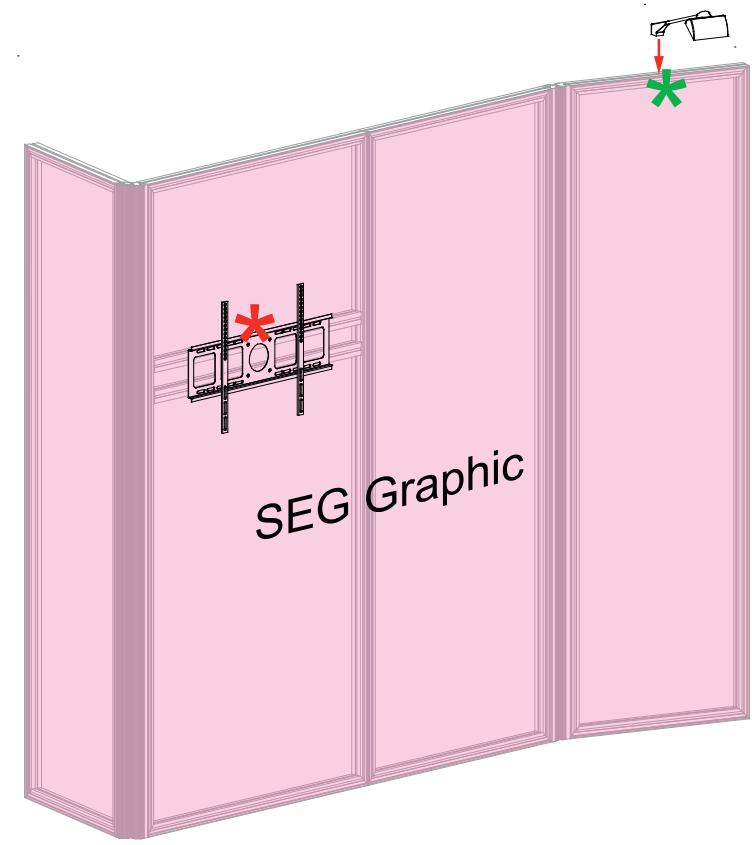

SETUP INSTRUCTIONS

Side-by-Side Assembly

- 1) Frames: Place frames side-by-side with one higher than the other, then slide panel down to lock panels securely together.
- 2) Corner Connectors: Repeat Step 1 for installing corner connectors to frames.

Side-by-Side Disassembly

- 1) Pull pin lock outwards to disengage.
- 2) Pull frames upward and apart at the same time to detach.

Assembly

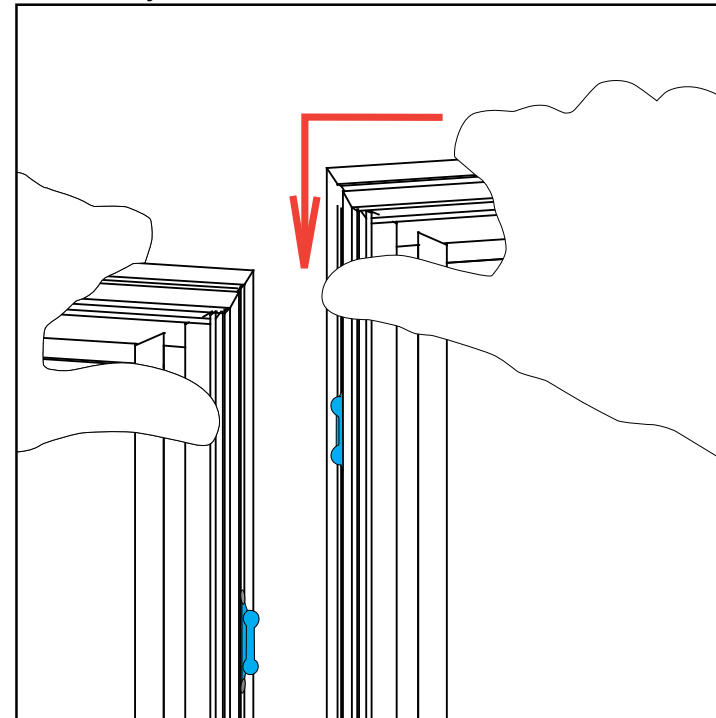

Assembly Cont'd

Push pin lock into hole of connecting frame.
Note: Block of pin lock will secure in groove.

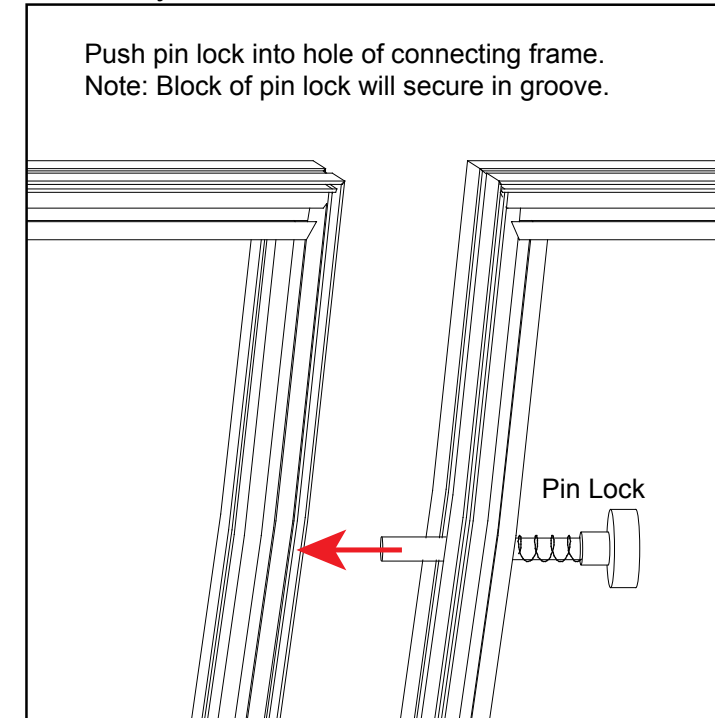

Corner Connector

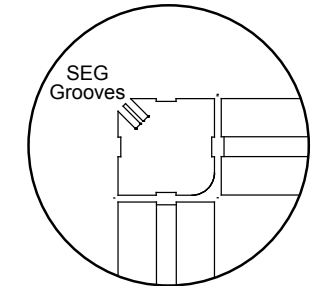

Top View

Note: Orientation of Corner Connector may change.

Stacking Assembly

- 1) Place one horizontal frame on top of the other, lining up the center grooves.
- 2) Turn stacking lock clockwise to tighten into place. Repeat for each lock.

Stacking Disassembly

- 1) Turn the stacking lock counter-clockwise to loosen.
- 2) The whole spring on the stacking lock should be in view to release each frame. The disengaged spring should release the stacking lock. If not, keep turning the stacking lock until it disengages.

Stacking

Push stacking lock into the slot of the upper frame, then spin the cap to tighten the lock.

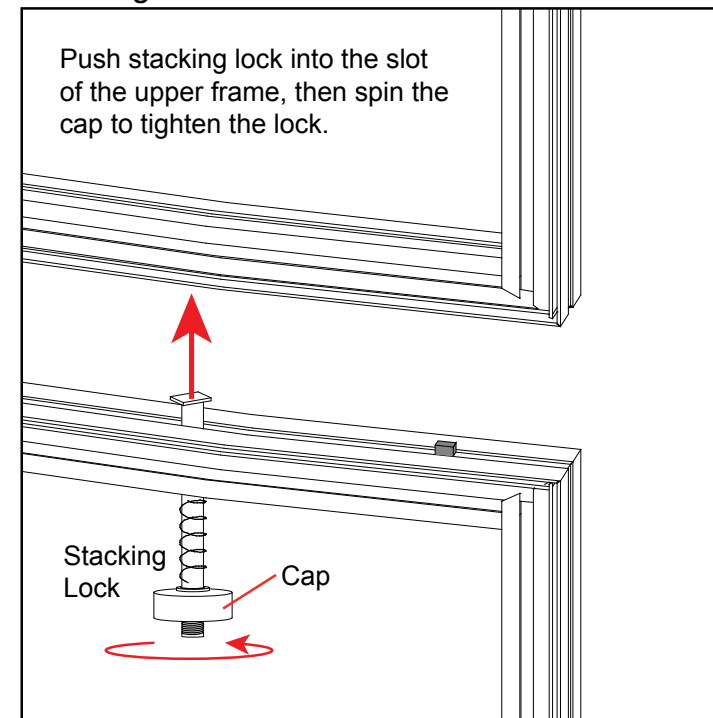

Unstacking

Disengage the stacking lock by spinning the cap counter clockwise and pulling down.

